

MALONE®

CHANGING THE WAY YOU GET THERE

VersaRail™

UNIVERSAL CROSS BAR SYSTEM

MPG220-221
& MPG224



! Important Notes: !

- Check Online vehicle fit guide before use.
- NOT SUITABLE FOR 2 DOOR VEHICLES.
- All items being carried (surfboards, sail boards, kayaks, ladders etc.) require the use of front and rear tie-down straps (not included). Bow and stern safety tie-downs are required for all Malone rooftop transport(s). Failure to correctly install and use safety tie-down lines voids all warranty and liability.
- This product May Not be Suitable for use on vehicles that are fitted with side curtain or overhead airbags. The straps can prohibit the airbags from deploying properly.
- Crossbars must be at least 24" apart for safe transport.
- Do not tamper with load strap and/or buckle while in transit.
- Do Not Use In Rain, water can potentially run down nylon strapping when wet and into vehicle.
- Remove the product before entering a carwash.
- Make sure your vehicle roof is clean from any dust and dirt before installing.
- The VersaRail™ has been designed as a temporary roof load carrying system and should not be left fitted to the vehicle when not in use.
- The VersaRail™ is NOT suitable for use with rooftop tents.

Installation & Loading Instructions - Please Read Before Beginning

Veillez lire les instructions avant d'entreprendre l'installation et le chargement

IMPORTANT WARNING: All vehicular transports are potentially hazardous. Any person(s) using Malone products are personally responsible for following the given directions for use and/or installation and accepts full responsibility for any and all damages or injury of any kind including death, which may result from their use and/or installation.

It is critical that all Malone racks and accessories be properly and securely attached to your vehicle. Improper attachment could result in a serious accident, and could cause serious bodily injury or death to you or to others. You are responsible for securing the racks and accessories to your car, checking the attachment's prior to use, and periodically inspecting the products for adjustment, wear, and damage.

You must read and understand all of the instructions and cautions supplied with your Malone products(s) prior to installation or use. If you do not understand all of the instructions and cautions, or, if you have no mechanical experience and are not thoroughly familiar with the installation procedures, you should have the product installed by a professional installer.

MALONE[®]

CHANGING THE WAY YOU GET THERE

Important Note

Product Warranty & Registration Form

All information is confidential and used exclusively by MALONE only.

Dear Customer,

Thank you for your purchase of a Malone Product.

In order to be eligible for the Malone Warranty program, we ask that you contact us online at the link provided below: With-in 30 days of purchase. You can also mail this letter back to the address at the bottom.

- Online: <https://maloneautoracks.com/product-registration.php>

We will require the information below.

Here is the information collected:

First Name: _____

Last Name: _____

Address: _____

Address2: _____

City: _____

State: _____

Zip: _____

Country: _____

Email: _____

Phone: _____

Product Description/Name: _____

Product MPG# _____

Date Purchased: _____

Store Where Purchased: _____

Purchase Price: _____

Thank you for choosing Malone!

MALONE AUTO RACKS 81 County Rd. Ste 1, Westbrook, ME 04092
P: 207.774.9100 F: 207.615.0551
E: support@maloneautoracks.com W: www.maloneautoracks.com

MALONE®

CHANGING THE WAY YOU GET THERE

VersaRail™

UNIVERSAL CROSS BAR SYSTEM

MPG220-221
& MPG224



Load Bars with Tower Attachment Brackets & Load Straps(2)



Towers (4)

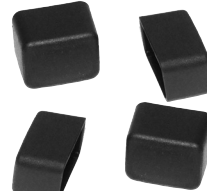

End Caps (4)



Hardware & Allen Wrench

Assembly & Use Instructions - Please Read Before Beginning

FOR USE WITH BARE ROOFED VEHICLES

Assembling The Cross Bars

1. Insert the tower attachment bracket into the top of the tower as pictured in figure 1.
2. Capture the nylon lock nut in the hex shaped hole of the tower. See Figure 2
3. Insert Allen bolt into the remaining round hole and secure with provided wrench. Do not over tighten. See Figures 3 & 3A
4. Add the end caps to cross bars. Push firmly to secure. See Figure 4. Repeat steps 1 thru 4 to complete remaining 3 towers.
5. With assembly complete, loosen the towers set screw on the underside of the tower attachment bracket. This will allow the tower to slide along the cross bar so we can fit it to the vehicle's width. NOTE: We will tighten this screw after fitting the vehicle. See Figures 5 & 5A

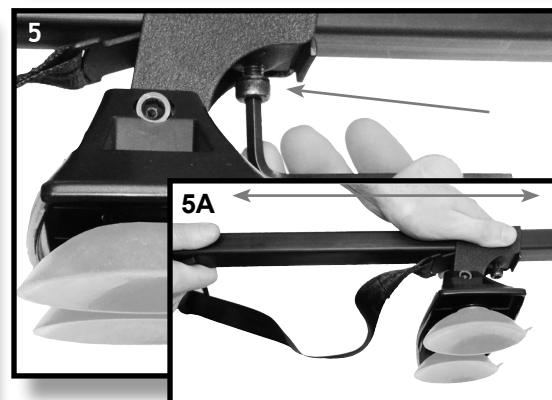
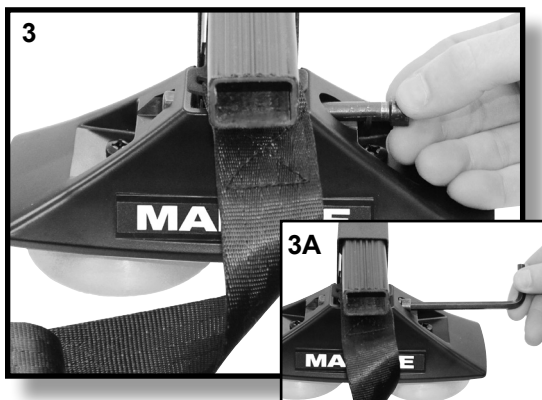

You should now have two(2) completely assembled cross bars ready to install.



Review the previous steps if yours does not look like the photo.



Important Notes:

- Check Online vehicle fit guide before use.
- **NOT SUITABLE FOR 2 DOOR VEHICLES.**
- All items being carried (surfboards, sail boards, kayaks, ladders etc.) require the use of front and rear tie-down straps (not included). Bow and stern safety tie-downs are required for all Malone rooftop transport(s). Failure to correctly install and use safety tie-down lines voids all warranty and liability.
- This product May Not be Suitable for use on vehicles that are fitted with side curtain or overhead airbags. The straps can prohibit the airbags from deploying properly.
- Crossbars must be at least 24" apart for safe transport.
- Do not tamper with load strap and/or buckle while in transit.
- Do Not Use In Rain, water can potentially run down nylon strapping when wet and into vehicle.
- Remove the product before entering a carwash.
- Make sure your vehicle roof is clean from any dust and dirt before installing.
- The VersaRail™ has been designed as a temporary roof load carrying system and should not be left fitted to the vehicle when not in use.
- The VersaRail™ is NOT suitable for use with rooftop tents.

Mounting The Cross Bars



IMPORTANT NOTE ON MOUNTING:



- **CAREFUL ATTENTION MUST** be made to the placement of the towers on the vehicles roof. This is a very critical step to safety and function.
- The proper placement is right along the edge of the roof, at it's strongest point. The vacuum cups will act as cushions or pads even if placed over roof ridge lines preventing a full seal.
- Do Not place towers inwards or on a glass sunroof.

Mounting The Cross Bars: Continued

1. Begin with opening the vehicle's doors and place cross bars in desired location. Measuring at least 24" between them See Figure 1
2. Slide the tower(s) along the cross bar and place the tower(s) as to close to the edge as possible (see more sample images below). See Figure 2
3. With the towers placed as to close to the edge as possible, secure the towers by firmly pressing them downwards securing them to the roof. See Figure 3
4. With the cross bars in position, Go back and fully tightening the towers set screw that we loosened in step 5 of the assembly. See Figure 4

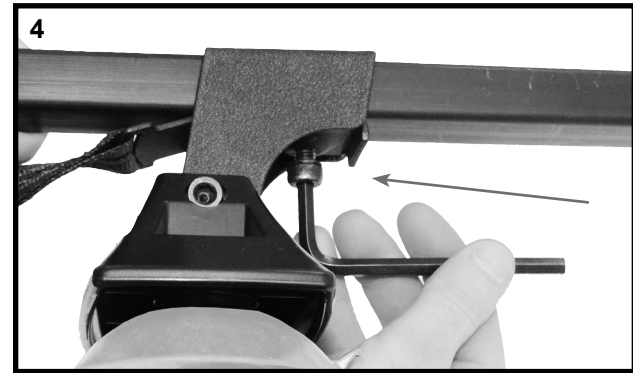
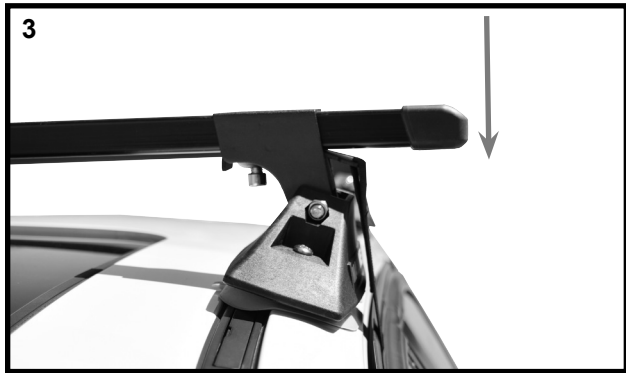
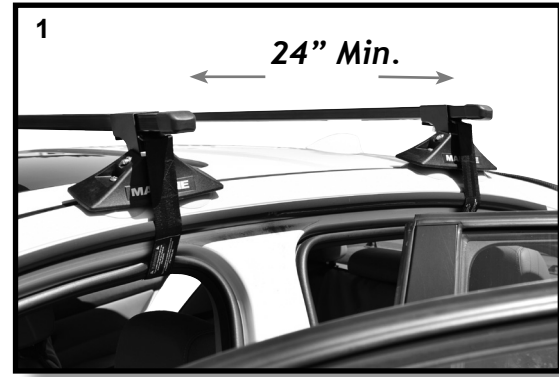

NOTE TOWER POSITIONS BELOW:

WRONG PLACEMENT



CORRECT PLACEMENT



Mounting The Cross Bars: Continued



5. Pull the load strap through the vehicle, and into the large cam buckle from the rear. See Figure 5



6. Pull firmly towards you to tighten. Push/pull the secured strap downwards to check the security/tightness. IF the strap loosens, re-do the strap through the back of cam buckle. See Figure 6&7



7. Neatly fold up any leftover strapping and secure with the hook and loop enclosure.

Your VersaRail™ system is now complete!

Be sure to double check all hardware and straps prior to transport.



Important Notes:



- Check Online vehicle fit guide before use.
- **NOT SUITABLE FOR 2 DOOR VEHICLES.**
- All items being carried (surfboards, sail boards, kayaks, ladders etc.) require the use of front and rear tie-down straps (not included). Bow and stern safety tie-downs are required for all Malone rooftop transport(s). Failure to correctly install and use safety tie-down lines voids all warranty and liability.
- This product May Not be Suitable for use on vehicles that are fitted with side curtain or overhead airbags. The straps can prohibit the airbags from deploying properly.
- Crossbars must be at least 24" apart for safe transport.
- Do not tamper with load strap and/or buckle while in transit.
- Do Not Use In Rain, water can potentially run down nylon strapping when wet and into vehicle.
- Remove the product before entering a carwash.
- Make sure your vehicle roof is clean from any dust and dirt before installing.
- The VersaRail™ has been designed as a temporary roof load carrying system and should not be left fitted to the vehicle when not in use.
- The VersaRail™ is NOT suitable for use with rooftop tents.

MALONE[®]

CHANGING THE WAY YOU GET THERE

Limited Five (5) Year Warranty

The Malone Auto Racks (Malone) Limited 5 Year Warranty covers certain Malone-brand products that have been specifically identified for inclusion in the program. This warranty is in effect for five (5) years, from the time of sale, for the original retail purchaser of the product. This warranty is terminated after five years from the date of purchase, or, when the original retail purchaser sells or otherwise transfers the product to any other person or entity during the five year warranty period.

Subject to the limitations and exclusions described in this warranty, Malone will remedy defects in materials and/or workmanship by repairing or replacing, at its option, a defective product without charge for parts or labor. Malone may elect, at its option, not to repair or replace a defective product but rather issue to the original retail purchaser a refund equal to the purchase price paid for the product, or credit to be used toward the purchase of a replacement Malone product.

This warranty does not cover, and no warranty is given for defects or problems caused by normal wear and tear, which includes, but is not limited to, surface (aesthetic) metal corrosion, scratches, dents, deformities, accidents, unlawful vehicle operation, or any modification of a product not performed or authorized in writing by Malone.

In addition, this warranty does not cover problems resulting from conditions beyond Malone's control including, but not limited to, theft, misuse, overloading, or failure to assemble, mount or use the product in accordance with Malone's written instructions or guidelines included with the product provided to the original retail purchaser.

No warranty is given for Malone products purchased outside of the continental United States, Canada and Mexico.

If the product is believed to be defective, the original retail purchaser should contact the Malone dealer from whom it was purchased, who will give the original retail purchaser instructions on how to proceed. If the original retail purchaser is unable to contact the Malone dealer, or the dealer is not able to remedy the defect, the original retail purchaser should contact Malone by email at support@maloneautoracks.com.

In the event that the product must be returned to Malone, a technician at the email address above will provide the original purchaser with return shipping instructions. The original purchaser will be responsible for the cost of mailing the product to Malone. In order to be eligible to receive any remedy under this warranty, a copy of the original purchase receipt, a description of the defect and a return address must be provided.

Disclaimer of Liability

Repair or replacement of a defective product, or the issue of a refund or credit (as determined by Malone) is the original retail purchaser's sole and exclusive remedy under this warranty. Damage to original purchaser's vehicle, cargo, or property, and/ or to any other person or property is not covered by this warranty.

This warranty is expressly made in lieu of any and all other warranties, express or implied, including the warranties of merchantability and fitness of a particular purpose

Malone's sole liability to any purchaser is limited to the remedy set forth above. In no event will Malone be liable for any direct, indirect, consequential, incidental, special, exemplary, or punitive damages , or, for any other damages of any kind or nature (including but not limited to, lost profits, lost income or lost sales).

Some states do not allow the exclusion or limitation of incidental or consequential damages, so the above limitations may not be applicable.

In addition, all vehicular transports are potentially hazardous. Any person(s) using Malone products are personally responsible for following the given directions for use and/or installation and accepts full responsibility for any and all damages or injury of any kind including death, which may result from their use and/or installation.

MALONE AUTO RACKS 81 County Rd. Ste 1, Westbrook, ME 04092

P: 207.774.9100 F: 207.615.0551

E: support@maloneautoracks.com W: www.maloneautoracks.com